



# LAUNDRY SOLUTIONS: ON-PREMISE, COMMERCIAL & INDUSTRIAL

## The multi-feature premium laundry dispenser for smaller facilities

V-Line is the perfect on-premise laundry system for smaller facilities where value and flexibility are critical but performance must be second to none. V-Line features a modular design to accommodate up to 6 pumps and uses the proven performance of DEMA's standard Quick Change Blue Pump at 16 ounce (475 ml) per minute or the Large Blue QC Pump for 50 ounces (1500 ml) per minute.



## Features & Benefits

- Designed to be fast and convenient for smaller OPL installations
  - Pre-wired for main power and trigger signals
  - Optional Magnetic Field Sensor eliminates direct trigger wiring
  - Flexibility to program in either volume (oz/ml) or time
- Can be used with up to 6 pumps or 5 pumps with a flush manifold
- Intuitive menu driven programming on dispenser
  - Digital display in 4 languages - English, Spanish, French and Portuguese
  - Program up to 9 formulas with password protection
- Modes of operation include:
  - FORMULA-SELECT that allows for multiple formula selection
  - RELAY which allows laundry machine to control all functions of the dispenser
  - SEQUENCE that's used on non-programmable, fixed time machines
  - MANUAL START on unit or with remote and no wiring to machine
- Formula select has two modes of operation
  - Auto formula select using trigger signal from laundry machine
  - Optional end user remote allows for convenient manual formula selection



**Optional V-line remote  
preinstalled for fast set-up**

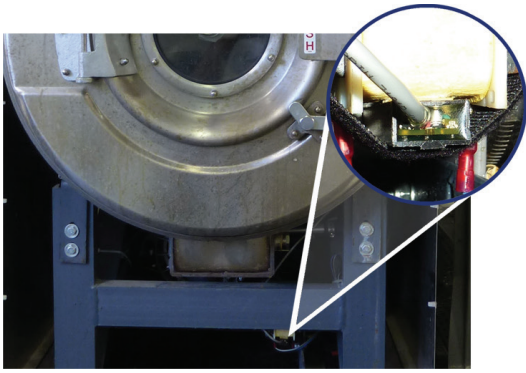

## Magnetic Field Sensor

DEMA'S Magnetic Field Sensor is the unique pump activator that requires no wiring to machine to simplify installation, reduce install time and create a safer environment for the installation.

- Sensor attaches easily to drain valve and activates the pump in SEQUENCE mode
- Provides laundry machine interface for sequence or "drain" mode applications and multiple signal applications

## ORDERING INFO

**8410B.30.F**  
**8410B.40.FR**  
**8410B.50.R**  
**Dispenser**

8410 = V-Line OPL Dispenser  
**Pump**

B = Pump with Barb  
 J = Pump with JG Fitting

**# of Pumps**

30 = 3 Pumps

40 = 4 Pumps

50 = 5 Pumps

**Valve and Remote Type**

F = Flush Valve

R = Remote

FR = Flush Valve & Remote

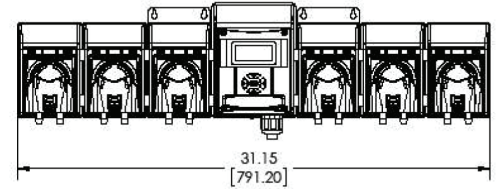
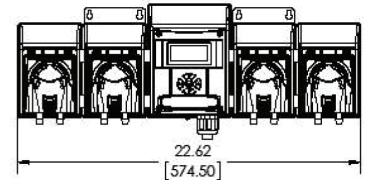
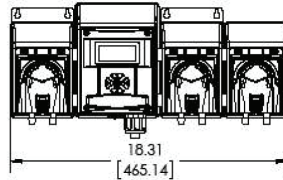
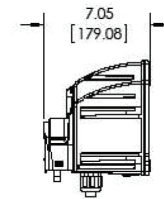
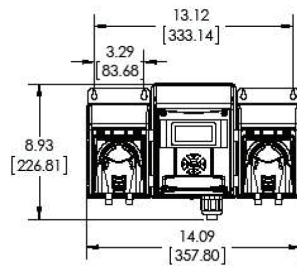

## SPECIFICATIONS

|                        |   |             |
|------------------------|---|-------------|
| Main Power             | 100/250 VAC 50/60 HZ (115 VAC plug factory installed) ON/OFF Main Power Switch                            |             |
| Case Material          | ABS   |             |
| Environmental Temp.    | 32-104F °   | 0-40 C °    |
| Pump Motor Rating      | 24 VDC  |             |
| Pump Output            | 16 oz. / min  | 475ml / min |
| Squeeze Material       | EPDM, Silicone, Viton, Supertube  |             |
| Trigger Signal         | Pre-wired 20-250 VAC  |             |
| Flush Manifold Options | V-Line with pre-installed flush valve<br>951 flush manifold (with or without valve) push or barb fittings |             |



### DEMA Engineering Company

10020 Big Bend Road  
 St. Louis, MO 63122 U.S.A

Tel: 314.966.3533  
 Fax: 314.965.8319



[www.demaeng.com](http://www.demaeng.com)



[sales@demaeng.com](mailto:sales@demaeng.com)